

Acceptable Plug  $\phi 0.60 \sim \phi 0.38\text{mm}$  , Socket Pins

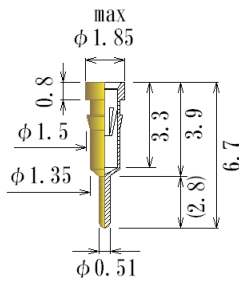

**J0010-GG**  
(J-01contact)

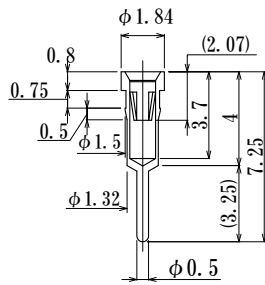

**J0010-GG-JV11**  
(JV11contact, value type)

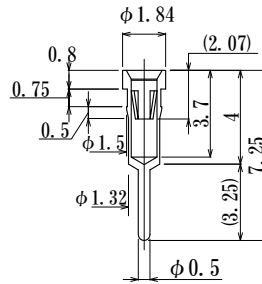

**J0010-GG-634**  
(J-634contact, High force)

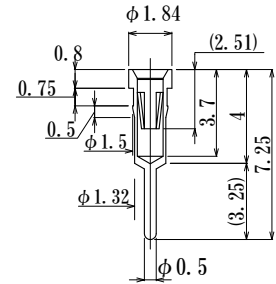

**J0010-GG-856**  
(J-856contact, Low force, Six fingers)  
Make to Order

Make to Order

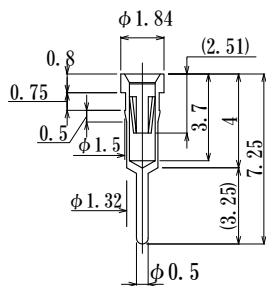

**J0010-GG-ST**  
(Value type)

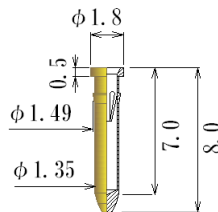

**JSC0021-GG**

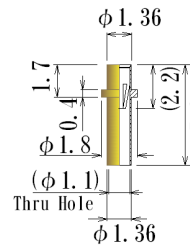

**JOKP50-GG**

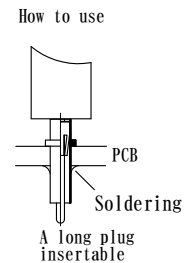

(J-01)

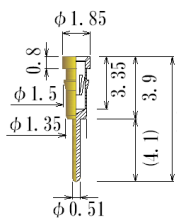

**JL0020-GG**

(J-01)

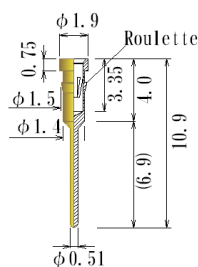

**JLL0020-L-GG**

(J-03)

Low Force

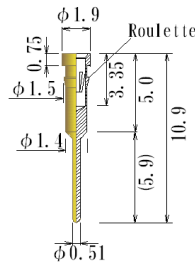

**JLL0021-GG**

(J-01)

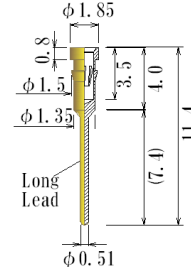

**JL74X11.4-L-GG**

Low Force

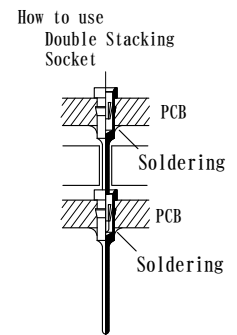

(J-03)

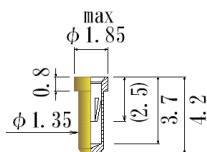

**JS0020-GG**

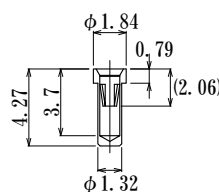

**JS0020-GG-ST**

(JV11contact, value type)

Make to Order

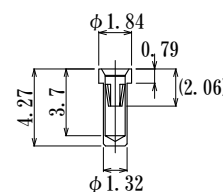

**JS0020-GG-634**

(J-634contact, High force)

Make to Order

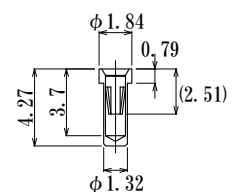

**JS0020-GG-856**

(J-856contact, Low force, Six fingers)

Make to Order

Acceptable Plug  $\phi 0.60 \sim \phi 0.38\text{mm}$  , Socket Pins

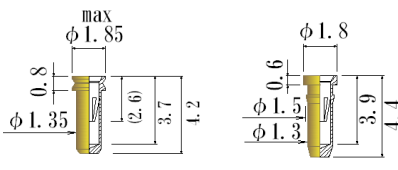
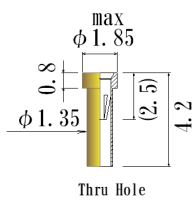
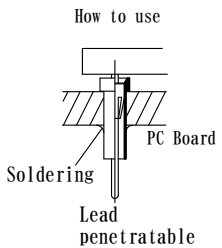
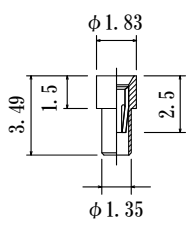
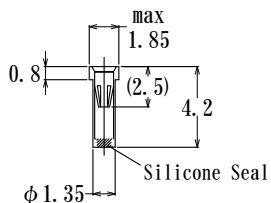
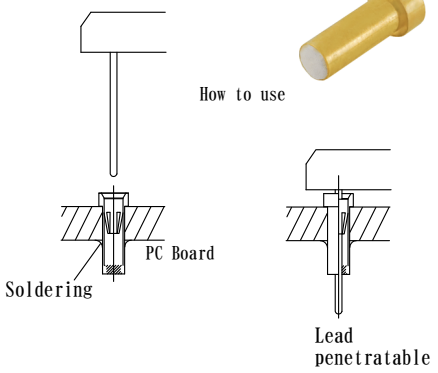
 <p><b>JSV0020-GG</b>      <b>JQ21-GG</b></p> <p>(J-01)</p>	<p>Thru Hole Socket Pin</p>  <p>Thru Hole</p> <p>How to use</p>  <p>Soldering</p> <p>PC Board</p> <p>Lead penetratable</p> <p><b>JSP0020-GG</b> (Sleeve Gold Plated) <b>JSP0020-SN</b> (Sleeve Sn Plated)</p> <p>(J-01)</p>
 <p>Thru Hole</p> <p><b>JSP0021-GG</b></p> <p>(J-01)</p>	<p>Thru Hole Socket Pin with Silicone Seal</p> <p><b>JSP0020-GG-TF</b></p>  <p>Silicone Seal</p> <p>How to use</p>  <p>Soldering</p> <p>PC Board</p> <p>Lead penetratable</p> <p>(J-01)</p>

Acceptable Plug  $\phi 0.60 \sim \phi 0.35\text{mm}$  , Socket Pins

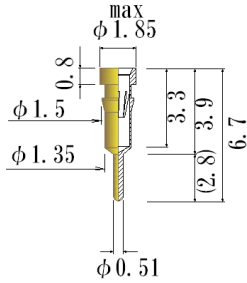

Acceptable plug:  
 $\phi 0.60 \sim \phi 0.40$   
**J0010-L-GG**

Low Force

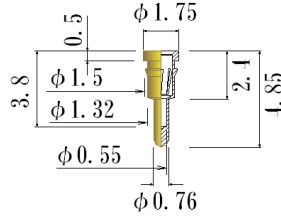

Acceptable plug:  
 $\phi 0.60 \sim \phi 0.40$   
**JS0041-1L-GG**

Low Force

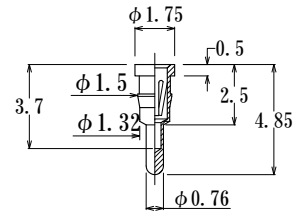

Acceptable plug:  
 $\phi 0.60 \sim \phi 0.40$   
**JS0041B-GG**

(J-03)

(J-01)

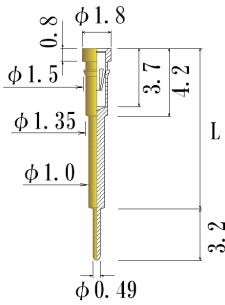

Parts Number	L Length
<b>JH0060-GG</b>	6.0
<b>JH0080-GG</b>	8.0
<b>JH0102-GG</b>	10.2
<b>JH0120-GG</b>	12.0
<b>JH0150-GG</b>	15.0

Acceptable Plug Range:  $\phi 0.60 \sim \phi 0.35$

(J-01)

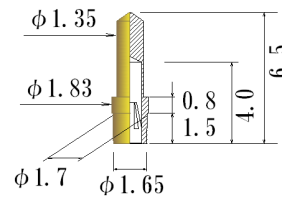

How to use

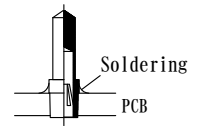

(J-01)

Acceptable Plug  $\phi 0.60 \sim \phi 0.35\text{mm}$ , Socket Pins

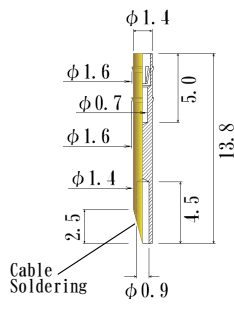

**J1-0510TL-GG**

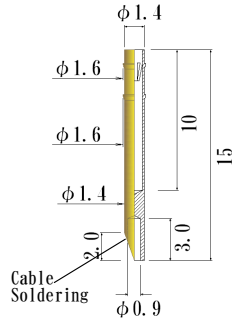

**J1-0620CH-GG**

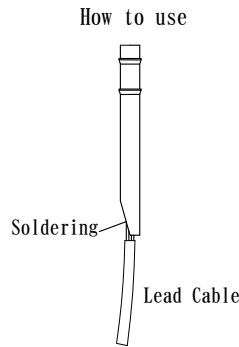

(J-01)

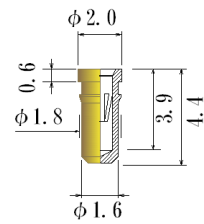

**JN0020-GG**

(J-01)

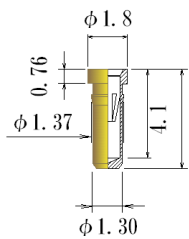

**J0137-L-GG**

Low Force  
(J-03)

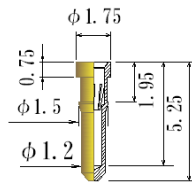

Acceptable plug:  
 $\phi 0.60 \sim \phi 0.40$   
**JS0062-L-GG**

Low Force  
(J-03)

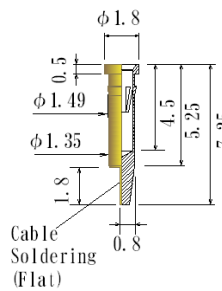

**JSC0030-GG**

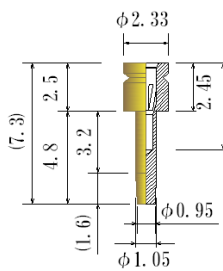

**NSB11V-GG**

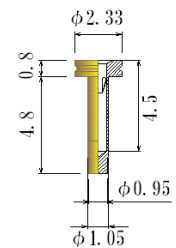

**NSB10V-GG**

(J-01)

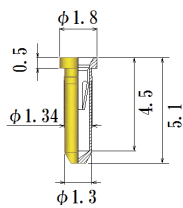

**J051-GG**

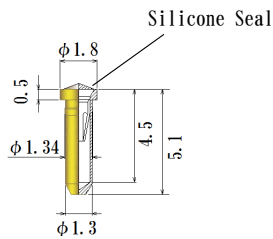

**J051-SGG**

Silicone Seal

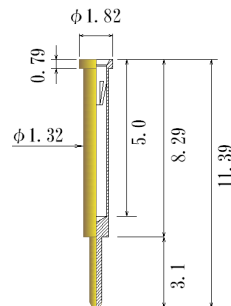

**J1139LAN-GG**

(J-01)

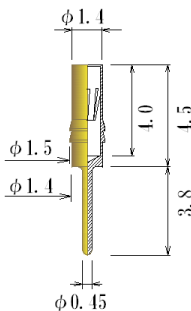

**JZ0010-L-GG**

Low Force

(J-03)

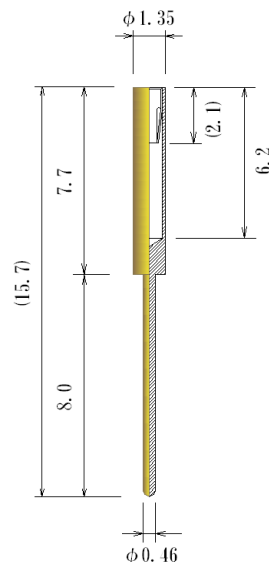
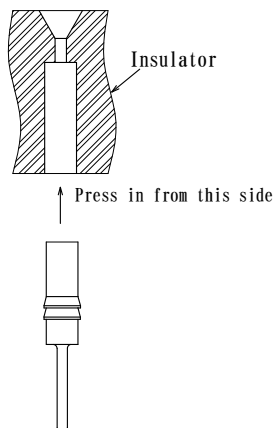

**JS135KM-GG**

(J-03)