

## SMC Connectors

SMC Connectors are similar to the SMB in general, but feature threaded couplings rather than snap-on types.

Nominal impedance	50Ω	
VSWR	DC~10GHz 1.3 max (in case of Semi-rigid cable)	
Insulation resistance	10000MΩ min at DC500V	
Dielectric withstanding voltage	AC500V 1 minute	
Temperature range	-30℃~+85℃	
Coupling Nut Force	155N (15.8kg) max	
Contact Mating force	0.49N (50g) min	
Contact durability	less than 10mΩ after 500 matings	
Material	Shell	Brass   Gold plated, Nickel plated
	Center Socket Contact	Beryllium copper   Heat treated, Gold plated

Specifications may be subject to change without notice.

### Mating Engagement

#### Plugs

#### Jacks

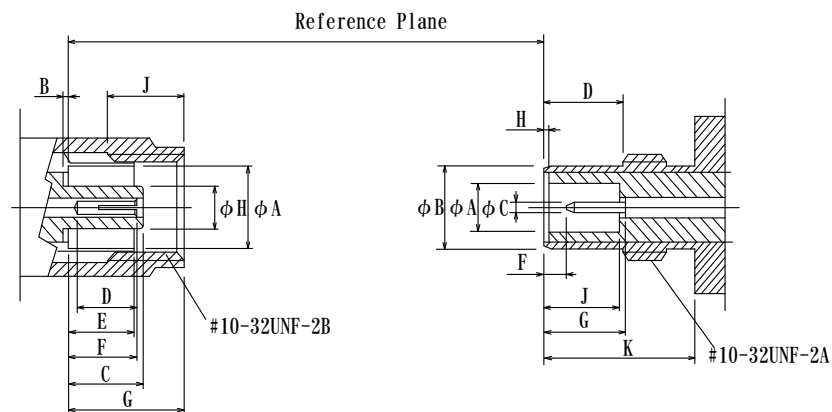

	Jack	
	min	max
A	3.73	3.81
B	0.00	0.30
C	3.15	3.40
D	2.79	-
E	-	3.10
F	3.05	3.40
G	-	5.92
H	2.00	2.06
J	2.79	-

	Plug	
	min	max
A	2.08	2.16
B	3.63	3.71
C	-	0.25
D	3.12	3.83
E	0.48	0.53
F	0.61	-
G	3.40	3.76
H	0.00	0.30
J	3.40	3.66
K	5.94	-

## SMC Connectors

### Plugs

#### SMCP-L-RG174

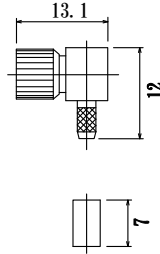

- Because of manufacture processing, this product is supplied only as a cable assembly. Please call our sales office.

Applicable Cable
RG-174/U, RG316/U

●Ni

### Jacks

#### SMC-LRN

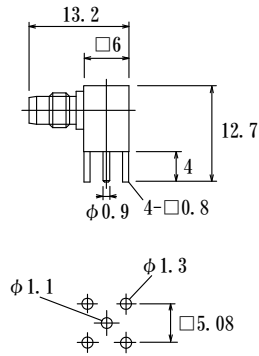

●Ni

#### SMC-LR\*

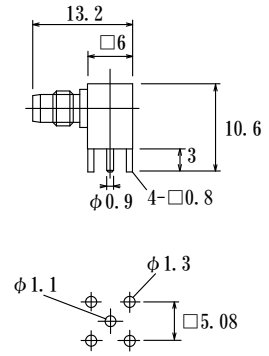

●Ni

### Bulkhead Receptacles

#### SMC-BR

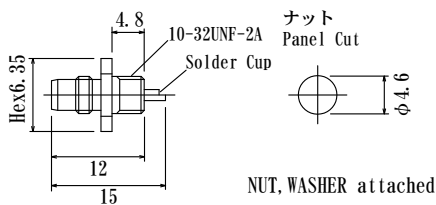

●Ni

### Between Adapter

#### SMCP-SMBJ\*

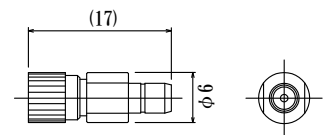

●Ni

### PCB Receptacles

#### SMC-BR-PC

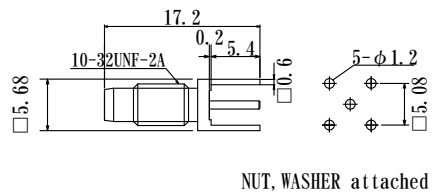

●Ni

#### SMC-R-PC

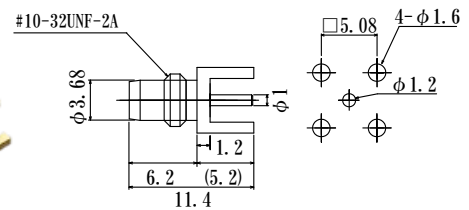

●Au

\* mark product is made only upon order.