

K2. 92mm Connectors

Compatible with SMA,
KS and 3.5mm connectors

K2.92 connectors have high performance up to 40GHz and compatible with SMA connector or 3.5mm connector.

Specifications		MIL-STD-348A	
Nominal impedance		50Ω	
VSWR		DC~40GHz 1.05+0.007f max f:GHz	
Insulation resistance		1000MΩmin at DC 500V	
Dielectric withstanding voltage		AC 500V 1minute	
Temperature range		-55℃~+125℃	
Coupling nut mating torque		10kgf (90N cm) max	
Contact mating force		0.49N (50gf) min	
Contact durability		less than 6mΩ after 500 matings	
Material	Shell	Stainless steel	Passivated, Gold plated, Nickel plated
	Coupling nut	Brass	
	Center Contact	Beryllium copper	Heat treated, Gold plated

Specifications may be subject to change without notice.

Interface Dimensions

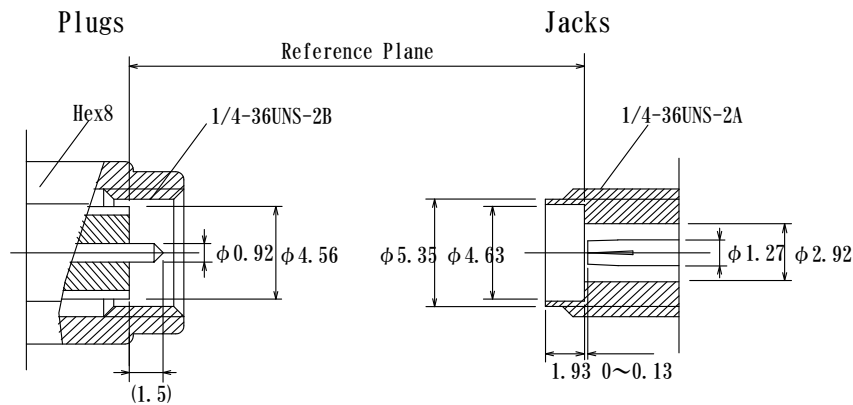

Semi-rigid cable, Solder direct type

Plugs

- KP-22S
- KP-16S
- KP-12S

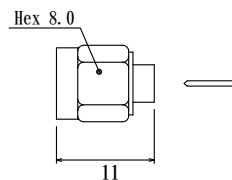
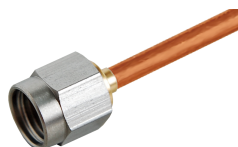

Part No.	Applicable Cable
KP-22S	RG-405/U 2.19mm/0.086"
KP-16S	SX-16 1.6mm/0.063"
KP-12S	SX-12 1.19mm/0.047"

●SUS Nut:Pa

* mark product is made only upon order.

K2. 92mm Connectors 40GHz

Semi-rigid cable, Solder Clamp type Rear Socket inside

Plugs

- KPC-22S
- KPC-16S *
- KPC-12S

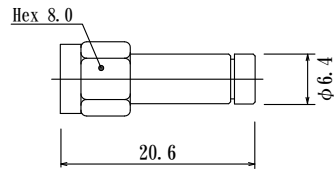

Part No.	Applicable Cable
KPC-22S	RG-405/U 2.19mm/0.086"
KPC-16S	SX-16 1.6mm/0.063"
KPC-12S	SX-12 1.19mm/0.047"

●SUS Pa

Semi-rigid cable, Solder Clamp type Rear Socket inside

Jacks

- KJC-22S-G
- KJC-16S-G *
- KJC-12S-G

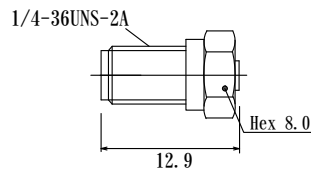

Part No.	Applicable Cable
KJC-22S-G	RG-405/U 2.19mm/0.086"
KJC-16S-G	SX-16 1.6mm/0.063"
KJC-12S-G	SX-12 1.19mm/0.047"

●SUS Au

Flange Mount Jacks, Semi-rigid cable, Solder Clamp type Rear Socket inside

Jacks

- KJR-22S-2G
- KJR-16S-2G *
- KJR-12S-2G

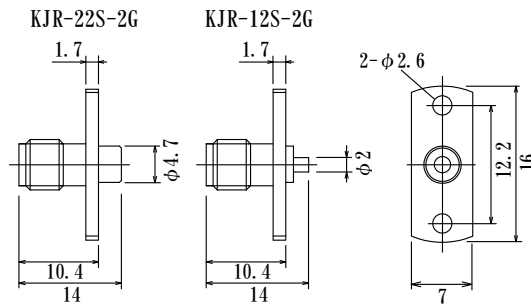

Part No.	Applicable Cable
KJR-22S-2G	RG-405/U 2.19mm/0.086"
KJR-16S-2G	SX-16 1.6mm/0.063"
KJR-12S-2G	SX-12 1.19mm/0.047"

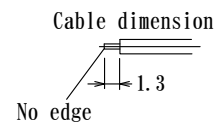

●SUS Au

Flange Mount Adapter

Jack to Jack KJJ-4T

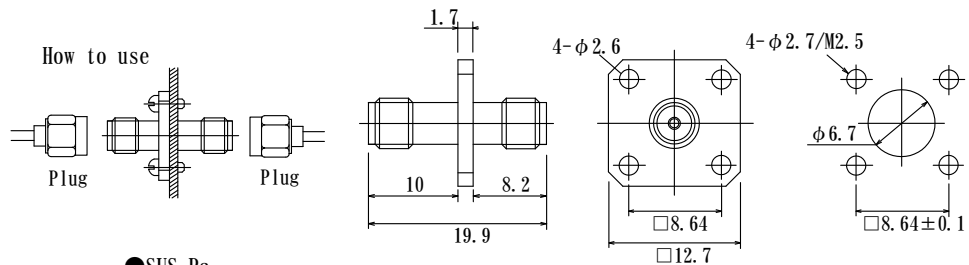

●SUS Pa

Adapter

Plug to Plug KPP-L220

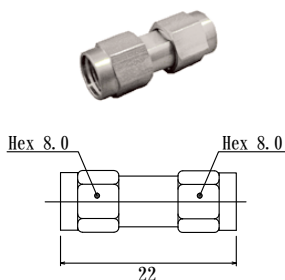

●SUS. Pa

Plug to Jack KPJ-L210

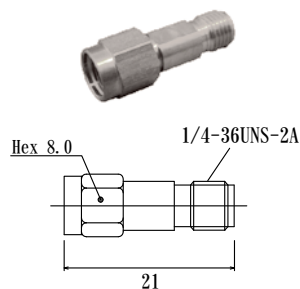

●SUS. Pa

Jack to Jack KJJ-L200

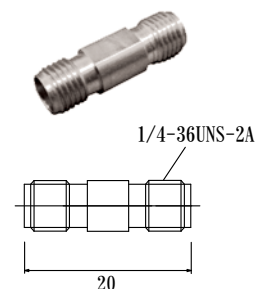

●SUS. Pa

* mark product is made only upon order.