

Plug $\phi 0.76\text{mm}$ Round pin connector

- Highly reliable round pin contact
- Mount to PC board
- Custom made welcome

Specification

Dielectric voltage: AC700Vrms 1min
Insulation resistance: 1000M Ω min
Contact resistance: 15m Ω max
rating current: 1.0 A
Temperature range: -55 $^{\circ}\text{C}$ ~ +150 $^{\circ}\text{C}$
(in case of gold plating)

Materials

Sleeve: Brass Ni plating over gold plating
Contact: Beryllium copper Gold plating over Ni plating

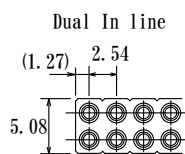
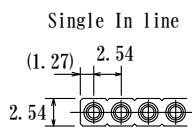
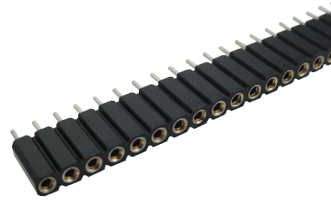

How to order

SPDK15-S36-GT

See below

Number of positions

D: Dual In Line
S: Single In Line

Socket

SPDK15-S36-GT

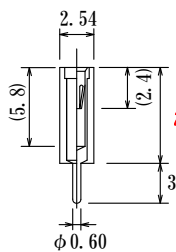

SPDK15-D72-GT

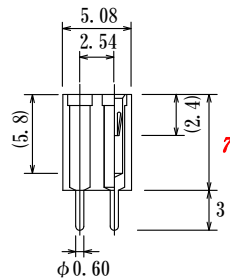

SPDK15R-S36L-GT

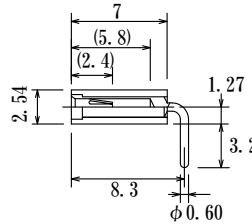

SPDK15R-D72L-GT

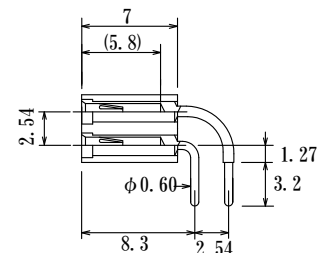

Plug

ISL76-S36-G112

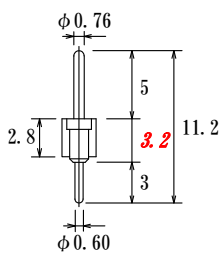

ISL76-D72-G112

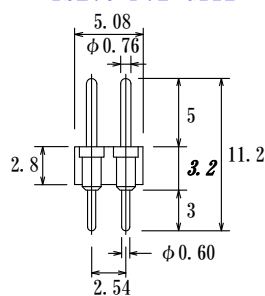

ISL76-S36L-G112

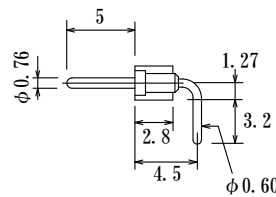

ISL76-D72L-G112

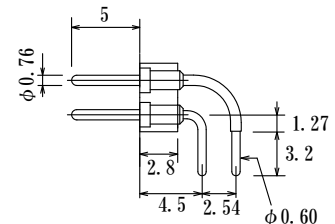

Mating configuration

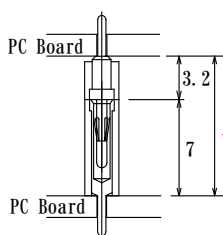

10.2

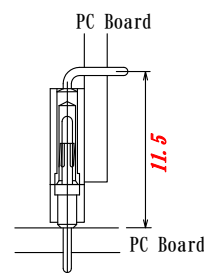
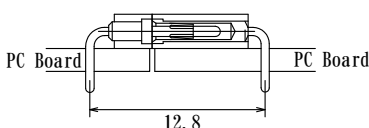

How to use

