

Signal Check Terminal

○For PC Board thru hole.

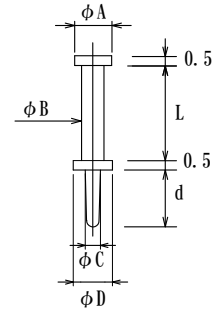
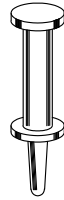

P/N	PCB hole dia.	φA	φB	φC	φD	L
MP-C100	φ0.8	1.8	1.2	0.8	2.0	3.0
MP-C101						6.0
MP-C102						10.0
MP-C110	φ1.0	2.2	1.4	1.0	2.5	3.5
MP-C111	φ1.2			1.2		6.5
MP-C062	φ0.6	1.2	0.8	0.6	1.2	5.0
MP-C052	φ0.5	1.0	0.7	0.5	1.0	5.0

Materials : Brass, Gold Plating over Ni Plating

How to use

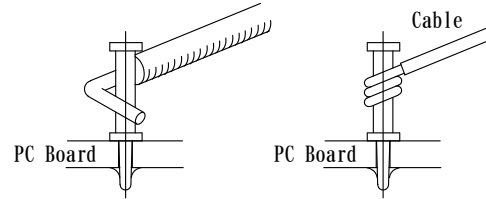

Spacer Pin

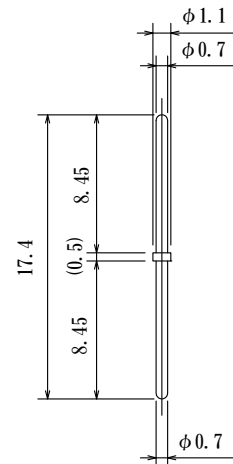
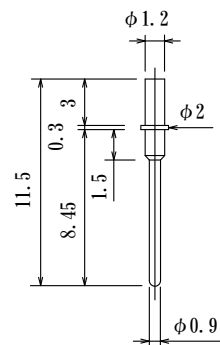
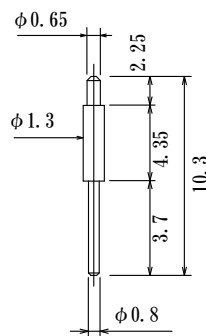
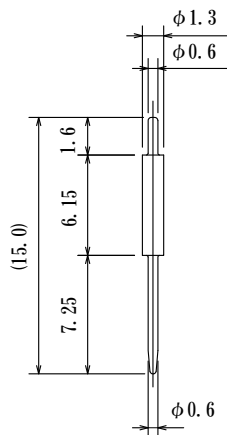

MP-F035-06-13X15-RK

Material : Phosphor bronze
Gold Flash over Ni plating

SDC-1021-SI

Material : Phosphor bronze
Gold plating over Ni plating

MP-G341-87

Material : Phosphor bronze
Gold plating over Ni plating

MP-SP-F07/174-RIK

Material : Phosphor bronze
Gold plating over Ni plating

Plate Two-tiered Pin

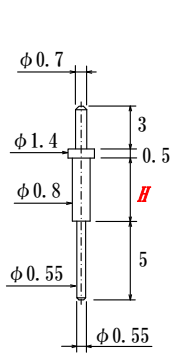

Gold Flash Ni Plating

P/N	H
MC-2D041-G	4.1
MC-2D066-G	6.6

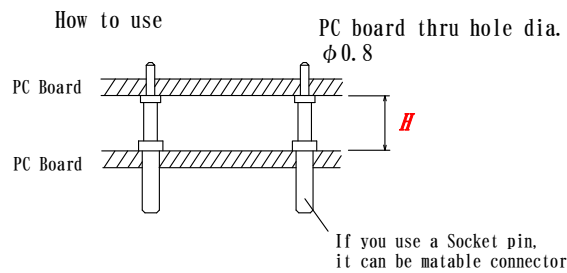
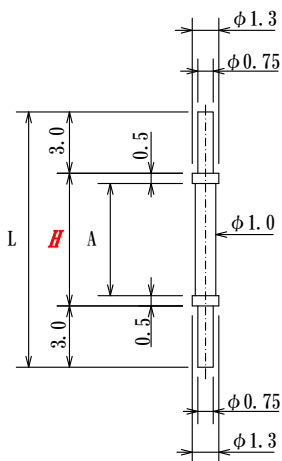
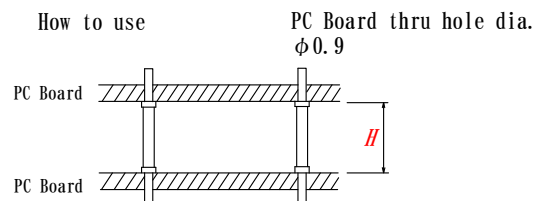

Plate Two-tiered Pin



Material : Brass
gold Flash Ni Plating

Part Number	A	H	L
MP-SAND40L-F	3.0	4.0	10.0
MP-SAND75L-F	6.5	7.5	13.5
MP-SAND120L-F	11.0	12.0	18.0
MP-SAND150L-F	14.0	15.0	21.0



0.85mm Round Terminal

Material : Phosphor bronze
Gold Flash over Ni plating

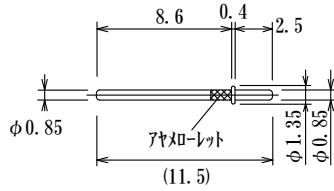

F085X124L



Kovar Round Terminal

Material : Kovar
Gold Flash over Ni plating

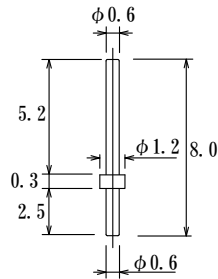

SJB-PIN

□0.64mm Wrapping Pins

Material : Phosphor bronze
Gold plating over Ni plating
PC board thru hole dia. : $\phi 1.0$

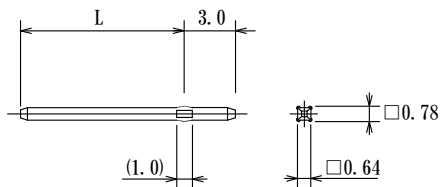

Part Number	Length L ± 0.15
HW-8	8
HW-10	10

