

Dsub Connectors, Shell size

Plug Shell Dimension

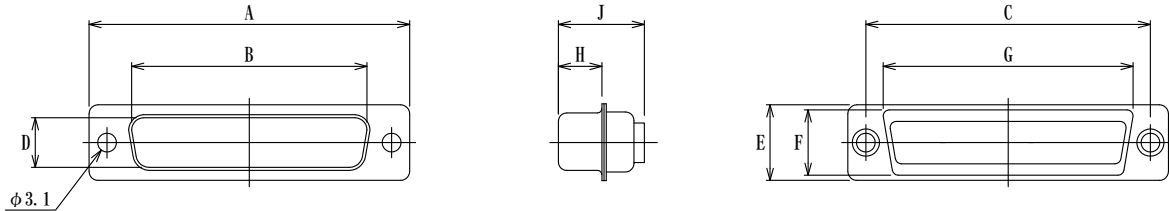

Shell Size	A	B	C	D	E	F	G	H	J
	±0.4	+0.2	±0.15	+0.2	±0.4	±0.3	±0.3	-0.3	-0.3
9	30.8	16.9	25.0	8.2	12.5	10.8	19.3	6.1	12.5
15	39.1	25.2	33.3	8.2	12.5	10.8	27.5	6.1	12.5
25	53.0	38.9	47.04	8.2	12.5	10.8	41.3	6.0	12.4
37	69.3	55.3	63.5	8.2	12.5	10.8	57.7	6.0	12.4
50	66.9	52.8	61.1	11.0	15.4	13.7	55.3	6.0	12.4

[mm]

Receptacle Shell Dimension

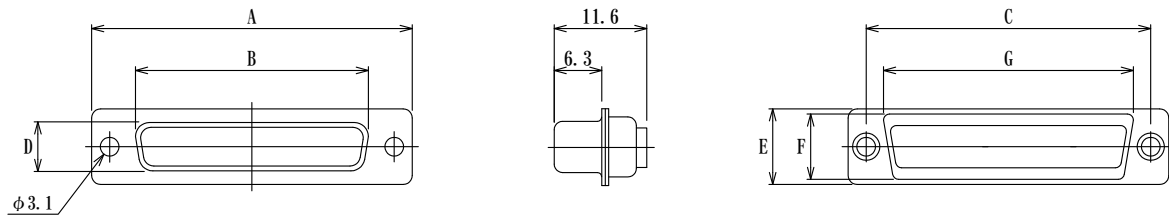

Shell Size	A	B	C	D	E	F	G
	±0.4	-0.2	±0.15	-0.2	±0.4	±0.3	±0.3
9	30.8	16.4	25.0	8.0	12.5	10.8	19.3
15	39.1	24.7	33.3	8.0	12.5	10.8	27.5
25	53.0	38.5	47.04	8.0	12.5	10.8	41.3
37	69.3	54.9	63.5	8.0	12.5	10.8	57.7
50	66.9	52.5	61.1	10.8	15.4	13.7	55.3

[mm]