

## High Current Socket Pin, thread type

- Screwing it into panels, or fixing to panels with nut.
- We welcome your custom design products.
- Larger plug dia. sockets are also available, please call us.
- Gold plating over Ni (Standard Product)

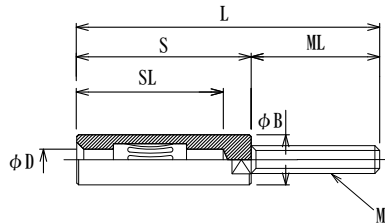

Part Number	Plug dia.	φB	φD	L	M	ML	S	SL	Current rating (A)	
<b>UJMST20AG</b>	2.0	5.5	2.2	33.0	M3x0.5P	coarse thread	14.0	19.0	15.5	20
<b>UJMST20AG-L360</b>	2.0	5.5	2.2	36.0	M3x0.5P		16.0	20.0	15.5	20
<b>UJMST30AG</b>	3.0	6.0	4.1	39.0	M4x0.7P		19.0	20.0	16.5	38
<b>UJMST40AG</b>	4.0	8.0	5.2	49.0	M5x0.8P		24.0	25.0	20.0	60
<b>UJMST40AG-L500</b>	4.0	7.0	5.2	50.0	M5x0.8P		25.0	25.0	19.8	60
<b>UJMST50AG</b>	5.0	8.3	5.9	50.0	M5x0.8P		25.0	25.0	20.0	66
<b>UJMST60AG</b>	6.0	9.6	6.8	52.0	M6x1.0P	fine thread	27.0	25.0	23.0	83
<b>UJMST80AG</b>	8.0	14.0	8.0	61.0	M8x1.0P		36.0	25.0	23.0	105

## Full thread Socket Pins

- Fixing to panels with nut.
- Both side insertable.
- Gold plating over Ni (Standard Product)

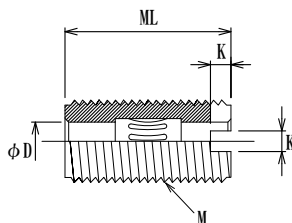

Part Number	Plug dia.	φD	M	ML	K	Current rating (A)
<b>UJMSW40AG</b>	4.0	4.3	fine thread	20.0	2.5	50
<b>UJMSW50AG</b>	5.0	5.2		24.0		66
<b>UJMSW80AG *</b>	8.0	8.2		M14X1.5P		105

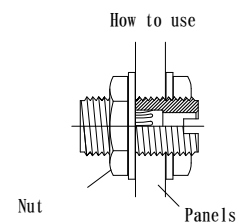

\* mark product is made only upon order.