

Single ended type 片端プローブピン
 Outer Dia. 0.50~0.69mm/ 0.0197" ~ 0.027"

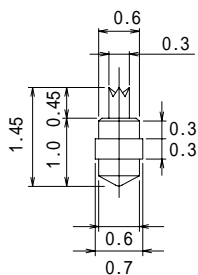

Glitter type



Full travel 0.3mm
 0.10N(10gf) at 0.25mm travel
 Initial load 0.04N(4gf)

8YKF70L145-10G1

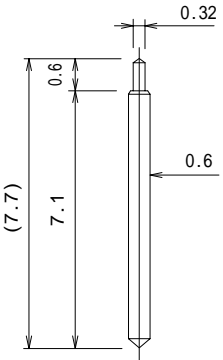
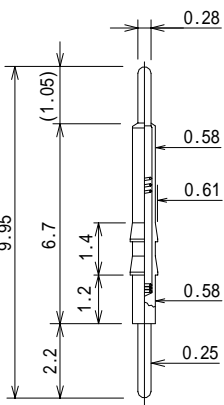
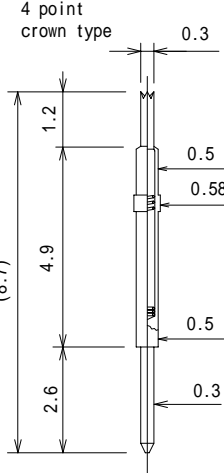
Single ended type 片端ノブピン
 Outer Dia. 0.50~0.69mm/ 0.0197" ~ 0.027"

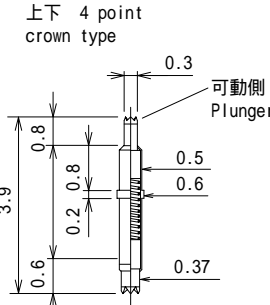
 <p>Full travel 0.5mm 0.3N(30.6gf) at 0.3mm travel</p> <p>8YJ-F60L77</p>	 <p>Full travel 1.05mm 0.20N(20.4gf) at 0.4mm travel</p> <p>8YF-K58L995G</p>	 <p>Full travel 1.2mm 0.22N(22.4gf) at 0.5mm travel</p> <p>8YF58L87</p>	 <p>Preload 4.0gf (0.039N) Full travel 2.0mm Current max 0.5A 0.09N(10gf) at 1.3mm travel</p> <p>8YD06878L-S1N-CONR2</p>
 <p>Full travel 0.8mm 0.29N(30gf) at 0.65mm travel</p> <p>8Y-GR-F06L39-KI</p>	