

Double ended probepin 両端プローブピン
 Outer Dia. 0.30/ 0.0118" or smaller

日本コネクト
 TEL 03(5706)4360
 FAX 03(5706)4363

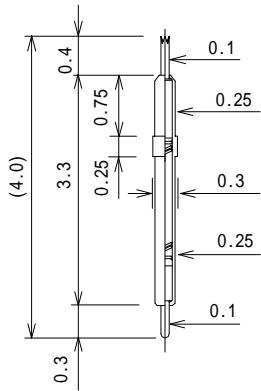

Full travel 0.5mm
 0.245N(25gf) at 0.4mm travel

8YK-D25H-L40I

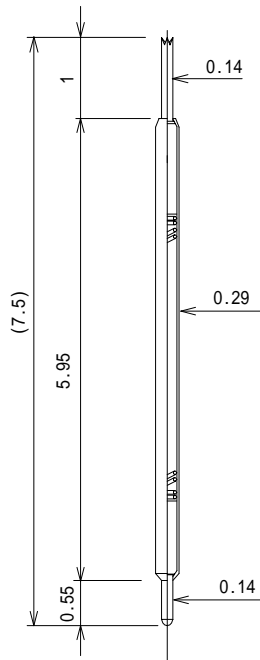

Full travel 1.2mm
 0.196N(20gf) at 0.9mm travel

8YK-D29H-L75-SI