

太めソケットピン Medium size Socket Pins

Acceptable Plug 0.70 ~ 0.60

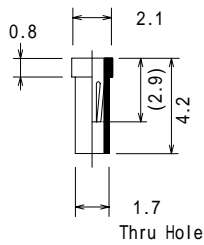

PDKP1540-GG

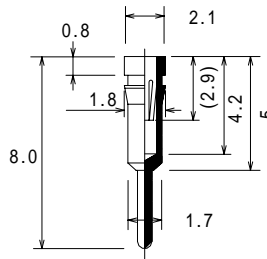

PDK1580-GG

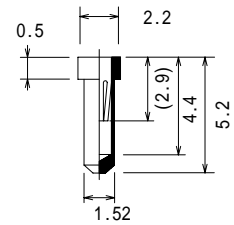

PDK1561-GG

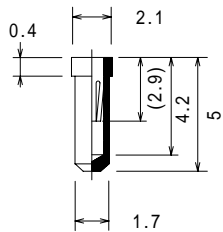

PDK1550-GG

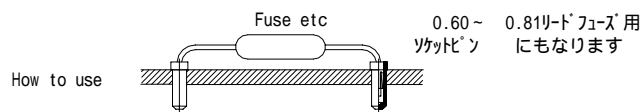
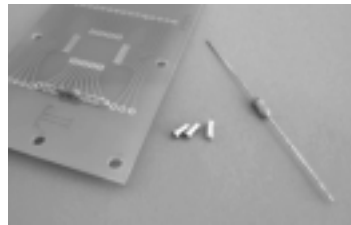

10764

Acceptable Plug 0.90 ~ 0.75

Medium mating force

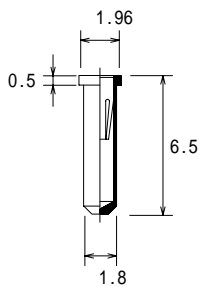

PDB65-GG

B

Acceptable Plug 0.85 ~ 0.80

High mating force

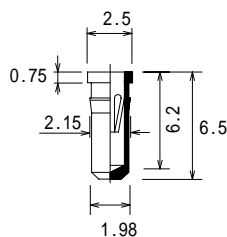

PDM2081-65-GG

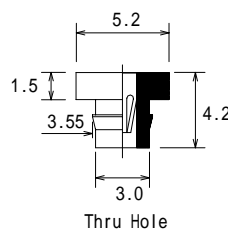

PDM2081-42-GG

M

太めソケットピン Medium size Socket Pins

for 2.0~ 0.60 plug dia.

Acceptable Plug 1.05~ 0.70

Medium mating force

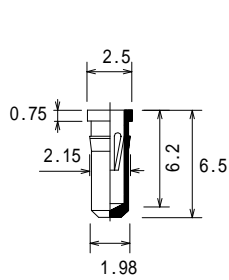

PDC2081-65-GG

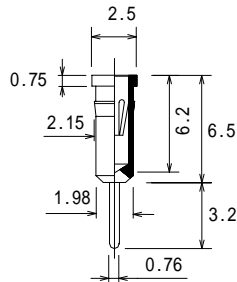

PDC2083-95-GG

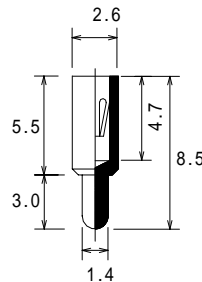

PDC2081-95-GG

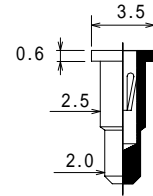

JS210M-GG

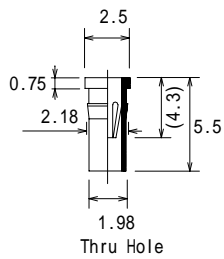

PDCP2081-56-GG

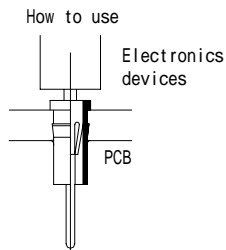

Thru Hole

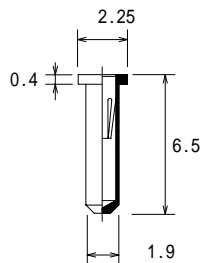

PDC65-GG



Custom Connector
(Example)

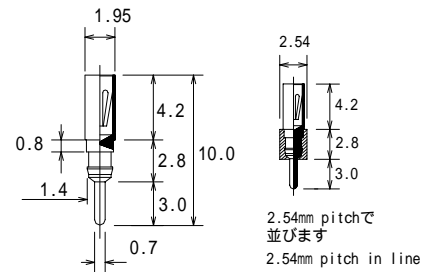

PIDC2010-GG

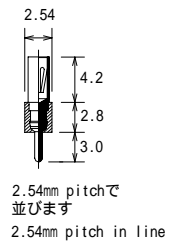

2.54mm pitchで
並びます
2.54mm pitch in line

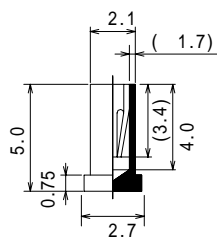

PDC20SM-50-GG

太めソケットピン Medium size Socket Pins

Acceptable Plug 1.10~ 0.90

Low mating force

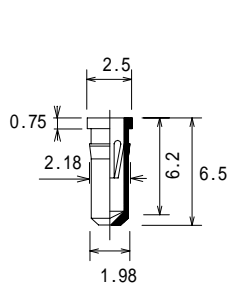

PDK2081-65-GG

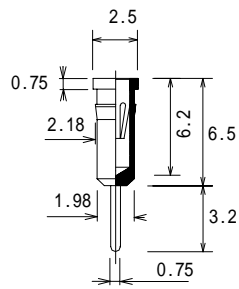

PDK2083-95-GG

10814

太めソケットピン Medium size Socket Pins

Acceptable Plug 1.50 ~ 1.30

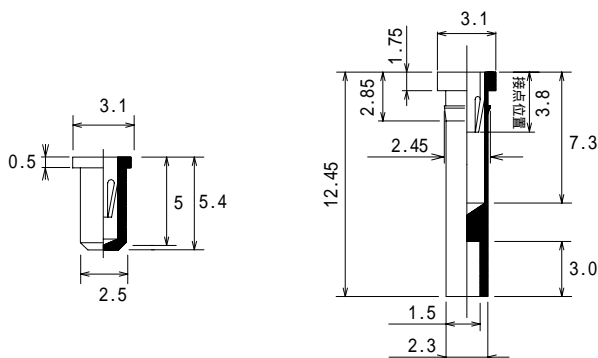

JS0330-GG

PDK2031-GG

10824

Acceptable Plug 2.0 ~ 1.70

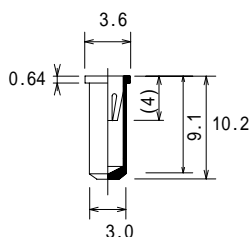

JS0400-GG

10834

PDB series
 PDM series
 PDC series
 PDK2 series

のご選定について How to choose Socket series

次表のように区別化されますので選定の基準にしてください。The differences are shown as follows.

Socket Series (品番のはじめの文字) (starting character)	挿入力 & 抜去力 Mating & Unmating Force	コネクタとしての 極数 Number of poles	適合リード 直径 Acceptable plug dia.	outer dia.	備考 remarks
PDB series	中間 Medium	少 small	0.90 ~ 0.75	1.6	Smaller outer dia.
PDM series	強い High	少 small	0.85 ~ 0.80	1.7	
PDC series	中間 Medium	中間 medium	1.05 ~ 0.70		
PDK2 series (非標準品)	弱い Low	多 many	1.10 ~ 0.90		Length=3.8mm

プラグ側がすでにお手元にあるときは、そのサンプルをお送り下されば、
 ご希望により近いソケットをご推奨します。
 If you send us the sample of plug, we can propose you suitable socket for your application.