

# J Series Socket Pins

Contact Resistance: less than 15mΩ  
 Acceptable Plug Range: φ0.35~φ0.60  
 Material Sleeve: Brass Gold over Ni plated, or Tin over Ni plated  
 Contact: Beryllium-Copper Gold over Ni plated  
 Operating Temperature: -55℃~+150℃

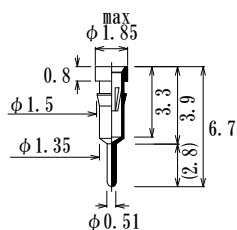

**J0010-GG**

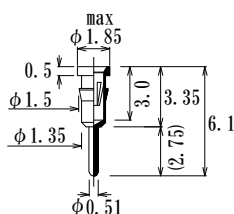

**J30-GG**

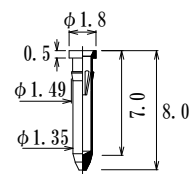

**JSC0021-GG**

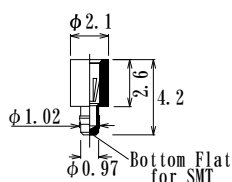

**SM1-GG**

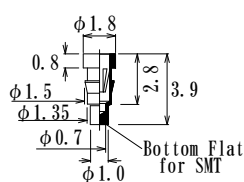

**JSM0039A-GG**

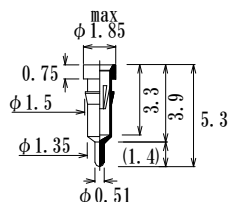

**JS0030-GG**

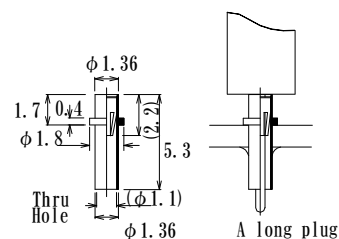

**JOKP50-GG**

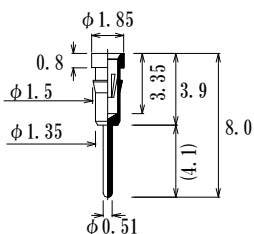

**JL0020-GG**

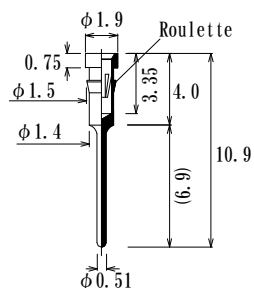

**JLL0020-GG**  
**JLL0020-L-GG**

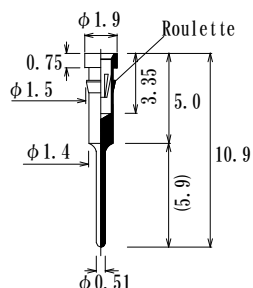

**JLL0021-GG**

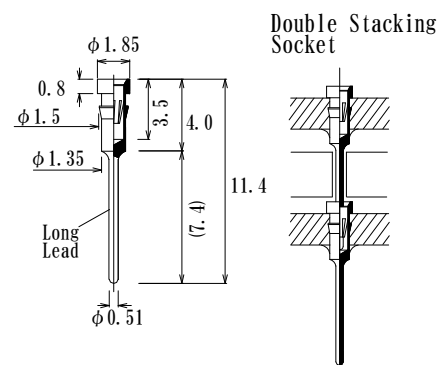

**JL74X11.4-L-GG**  
 Low Force

Low Force

注)

1. 多数のピンを並べたときに生じる、ピッチ誤差 (及び累積誤差) にご注意ください。
2. 同一ソケットピンに異なる直径のリードを挿抜するときは、直径差±0.02mm以内の範囲であれば、ほぼ変わらぬソケット特性が得られます。
3. 上記範囲以上ときは、太いリードを挿抜後、細いリードを挿抜すると、ソケットの挿抜が変化し、場合によっては劣化することがあるので、ご注意ください。

# J Series Socket Pins

Contact Resistance: less than 15m  
 Acceptable Plug Range: 0.60 ~ 0.35  
 Material Sleeve: Brass Gold over Ni plated , or Tin over Ni plated  
 Contact: Beryllium-Copper Gold over Ni plated  
 Operating Temperature: -55 ~ +150

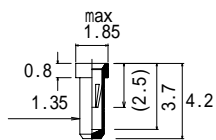

**JS0020-GG**

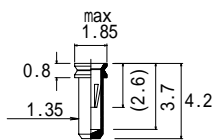

**JSV0020-GG**

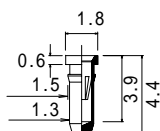

**J021-GG**

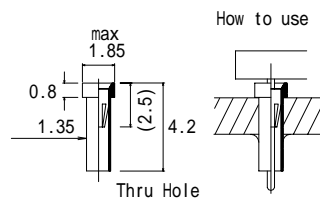

**JSP0020-GG**

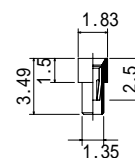

**JSP0021-GG**

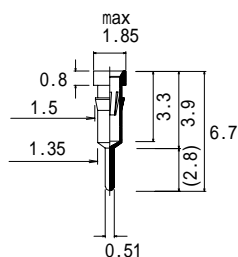

**J0010-L-GG**  
Low Force

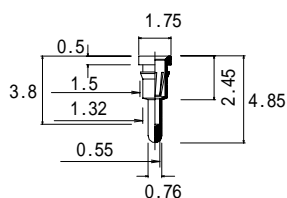

Acceptable plug:  
0.35 ~ 0.52  
**JS0041-L-GG**  
Low Force

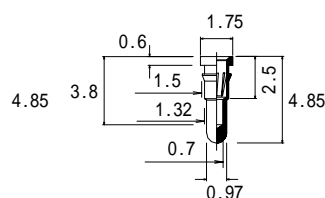

**JS0046-L-GG**  
Low Force

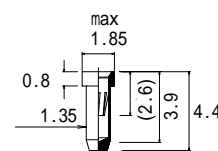

**J021-L-GG**  
Low Force

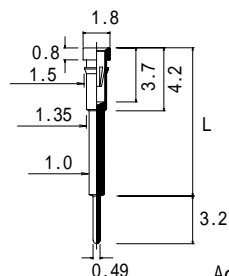

Patrs Number	L Length
<b>JH0060-GG</b>	6.0
<b>JH0080-GG</b>	8.0
<b>JH0102-GG</b>	10.2
<b>JH0120-GG</b>	12.0
<b>JH0150-GG</b>	15.0

Acceptable Plug Range: 0.35 ~ 0.58

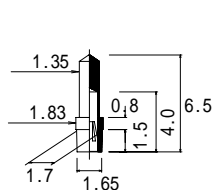

**JOK10-GG**

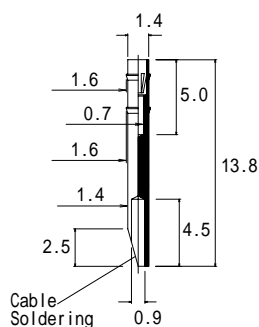
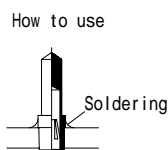

**J1-0510TL-GG**

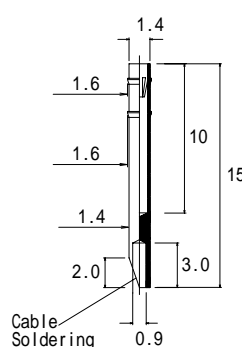

**J1-0620CH-GG**



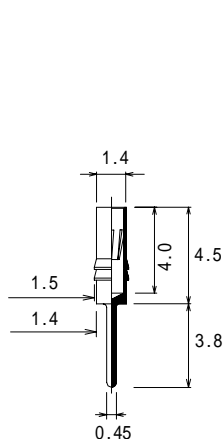

**JZ0010-L-GG**  
 Low Force

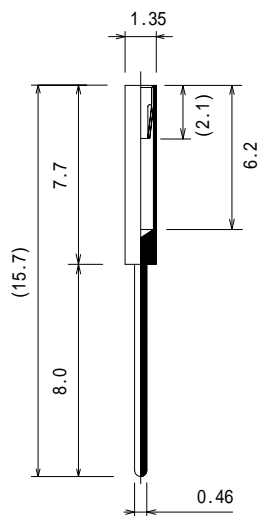

**JS135KM-GG**

## 高耐熱ソケットピン

Contact Resistance: less than 15m  
 Acceptable Plug Range: 0.45 ~ 0.52  
 Material Sleeve: Brass Gold over Ni plated  
 Contact: Stainless steel Gold over Ni plated  
 Operating Temperature: -55 ~ +350

200 max

使用例

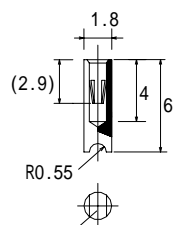

電線はここに溶接等で結線します。  
 Cable is welded here.

**JHT60CBL-GG**

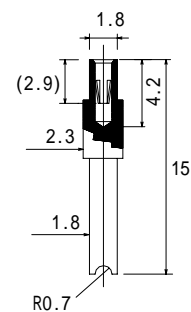

**JHT150-CBL-GG**