

N Series Socket Pins

Contact Resistance: less than 15mΩ

Acceptable Plug Range: $\phi 0.30 \sim \phi 0.52$

Material Sleeve: Brass Gold over Ni plated, or Tin over Ni plated
 Contact: Beryllium-Copper Gold over Ni plated

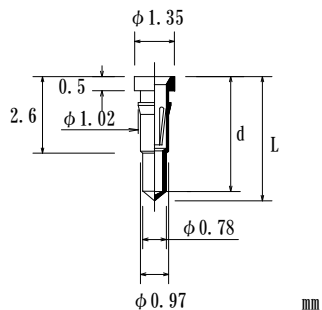

Parts Number	Length L	Depth d
NSV0020-GG	4.2	3.9
NSV0030-GG	5.0	4.1
NSV0040-GG	7.6	5.5

Why Silicone Seal Option?

- Usable at inferior environment.
- Specify when you wish to maintain higher reliability by means of half-closing contact point from outside environment.

シリコンシールの効用は次のとおりです。

- 環境の良くない所でのご使用。
- 接点部を外気から、半密閉して信頼性をさらに高めたいとき。

Silicone Seal

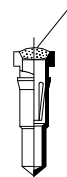

[NSVS0020-GG](#)
[NSVS0030-GG](#)
[NSVS0040-GG](#)

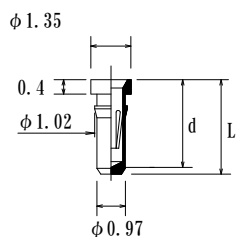

Parts Number	Length L	Depth d
NSF0010-GG	3.2	2.8
NSF11-GG	3.5	3.1
NSF12-GG	4.1	3.6

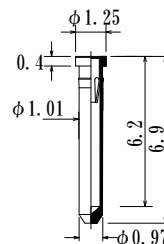

[NSF0035-GG](#)

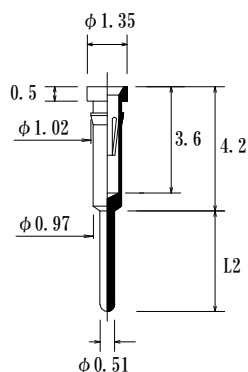

Parts Number	Length L2
N0010-GG	3.4
N0012-GG	2.8
N0014-GG	2.0

N Series Socket Pins

Contact Resistance: less than 15m
 Acceptable Plug Range: 0.52 ~ 0.30
 Material Sleeve: Brass Gold over Ni plated, or Tin over Ni plated
 Contact: Beryllium Copper, Gold over Ni plated

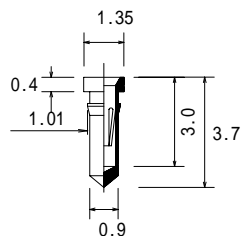

NSF18-GG

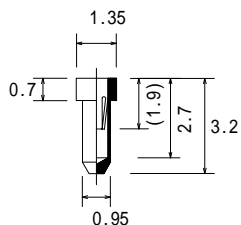

NSF20-GG

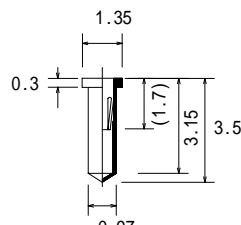

Acceptable Plug: 0.40max

NSF19-GG

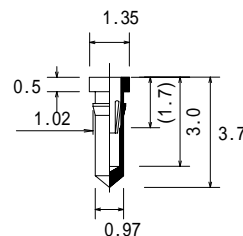

Acceptable Plug: 0.40max

RN0013-GG

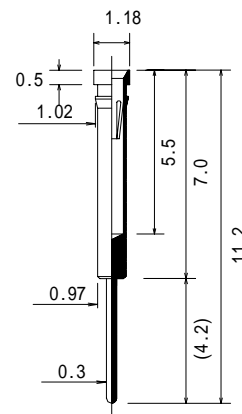

NA10-GG

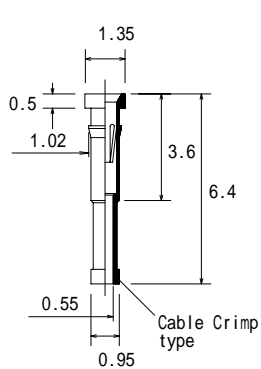

NLPS064-GG

適合電線
 AWG#26 ~ #30

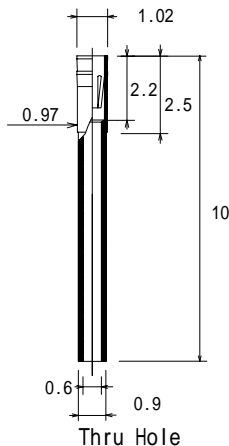

NZP100-GG

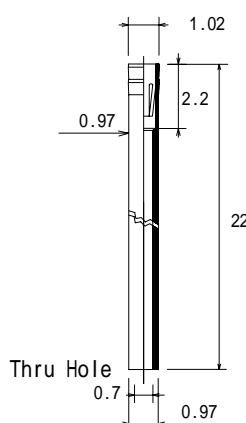

NZP220-GG

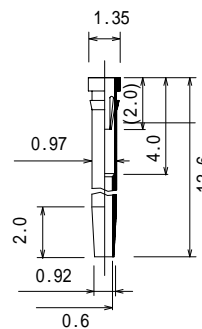

NSP126-GG

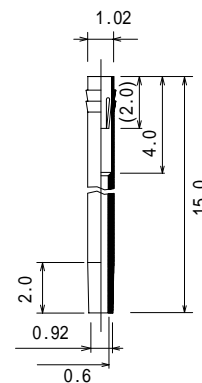

NZP10-GG

NY Series Socket pins

Contact Resistance: less than 15m
 Acceptable Plug Range: 0.42 ~ 0.35mm
 Material Sleeve: Brass Gold over Ni plated, or Tin over Ni plated
 Contact: Beryllium Copper, Gold over Ni plated

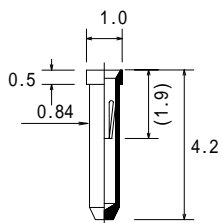

NY42-GG

Low Force

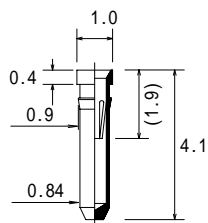

NY42HO-GG

Low Force

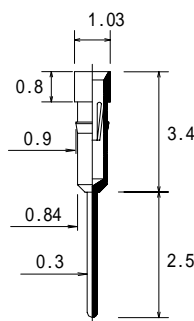

NZM10-GG

Low Force