

0.64 ~ 0.35mm plug, Socket Pins

Contact Resistance: less than 15m at 0.50mm plug

Acceptable Plug Range: 0.64 ~ 0.35mm

Material Sleeve: Brass Gold over Ni plated

Contact: Beryllium-Copper Gold over Ni plated
(N88contact)

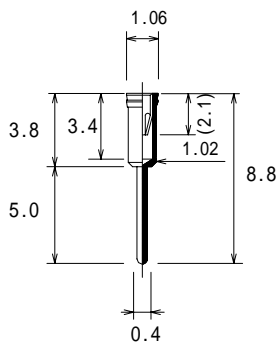

NZG8809-GG

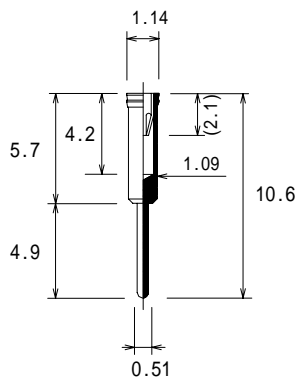

NZG88106-GG

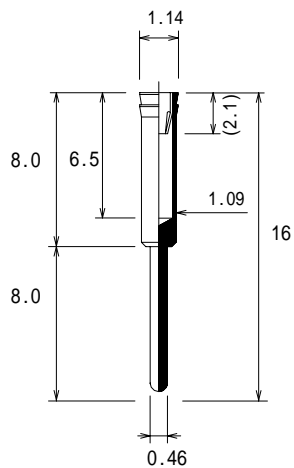

NZG8816-GG

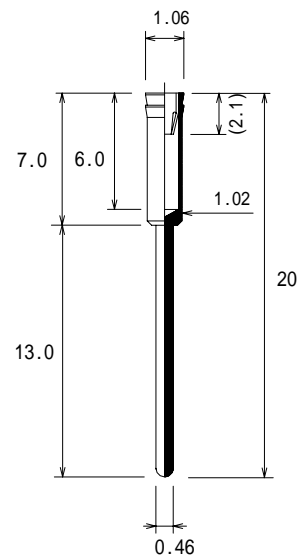

NZG8820-GG